

*Draft of a Piece of Land surveyed to Isaac E. Reed, situate in the District of Southwark, in the County of Philadelphia—*

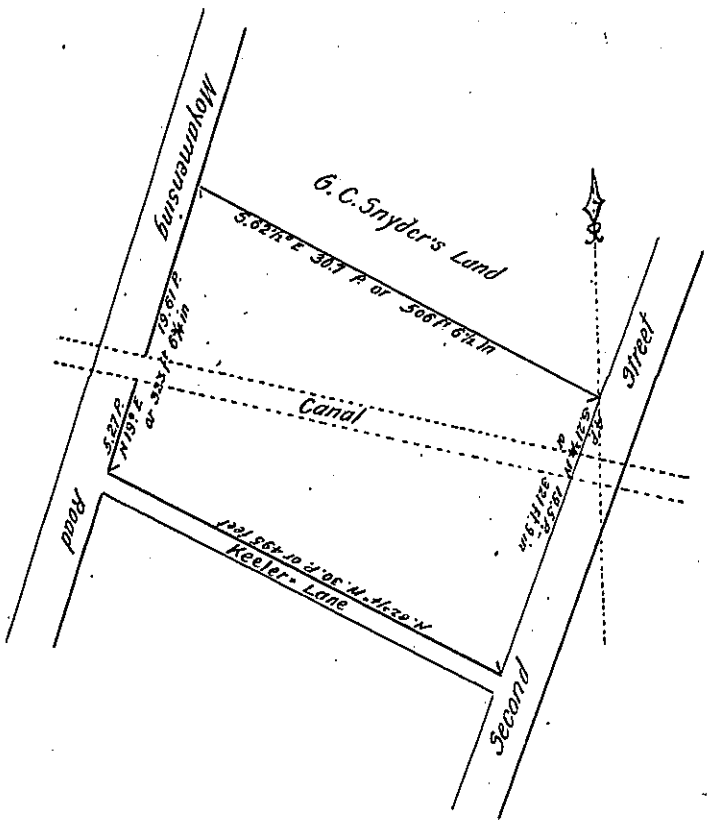

*Surveyed per Warrant, Dec. 20<sup>th</sup> 1838*

*by W<sup>m</sup> Kulp Jr.  
Deputy Surveyor*

*To John Taylor Esq. Surveyor General  
of the Commonwealth of Pennsylvania—*

*Pursuant to a warrant of survey dated 13<sup>th</sup> day of December A.D. 1838—to me directed whereby I was authorized and required to survey unto Isaac E. Reed of the County of Philadelphia "All that certain Lot or Piece of Ground containing in front on Hoopamensing road three hundred and nine feet more or less, on Keeler Lane four hundred and ninety four feet more or less, on Second Street continued three hundred and six feet more or less, and on the North four hundred and ninety six feet more or less, making in all as per survey— Acres bounded on the East (properly West), by Hoopamensing road on the South by Keeler Lane, on the West, (properly East), by Second Street continued and on the North partly by land now or formerly of G. C. Snyder, and partly by Moore Street, including an improvement, situate in the District of Southwark." I have made a survey thereof and have found the several bearings and distances to be as follows, to wit, Beginning at the North East Corner of Keeler Lane and Hoopamensing road, thence extending along the eastern side of said road, North, Nineteen Degrees East, Nineteen perches and sixty one hundredths to a Corner of G. C. Snyder's Land— thence by the said land, South sixty two and a half Degrees East, Thirty Perches and seven tenths to a Corner on the West side of Second Street continued, thence along the said Second Street South, Twenty one and three quarters Degrees East, Thirty Perches and seven tenths to a Corner on the West side of said Lane North sixty two and three quarters Degrees West, Thirty perches Degrees West, Nineteen perches and five tenths to Keeler Lane aforesaid, thence along the North side of said Lane North sixty two and three quarters Degrees West, Thirty perches to the place of Beginning, Containing three Acres, two quarters and twenty eight Perches of Land, be the same more or less, (including however the space thereof occupied by the commenced Canal which passes through the same as represented in the annexed draft, and also such part as may be occupied by Moore Street, if the same shall hereafter be opened— the Canal itself occupies sixty one perches*

*IN TESTIMONY that the above is a copy of the original remaining on file in the Department of Internal Affairs of Pennsylvania, made conformably to an Act of Assembly approved the 16th day of February, 1833, I have hereunto set my Hand and caused the Seal of said Department to be affixed at Harrisburg, this*

*twelfth day of December 1906.*  
*Geo. R. Brown*  
Secretary of Internal Affairs.